

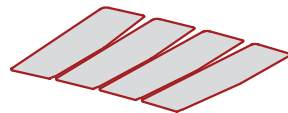

**teCom**  
Technology Components

**ergo**



Special

**SPECIAL PRODUCTS**

**2020**

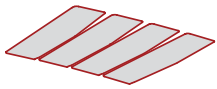



## Special products

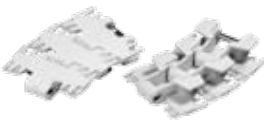

Part	Pag.
700 .....	147
701 .....	146
702 .....	146
703 .....	146
704 .....	147
705 .....	150
706 .....	150
710 .....	148
711 .....	149
Corner tracks .....	151
Straight tracks .....	151

**The products shown in this part are available only on request**

**Chains and accessories**

				
Part. 701 pag. 146	Part. 702 pag. 146	Part. 703 pag. 146	Part. 700 pag. 147	Part. 704 pag. 147
				
Part. 710 pag. 148	Part. 711 pag. 149	Part. 705 pag. 150	Part. 706 pag. 150	

**Corner and straight tracks**

	
Corner tracks pag. 151	Straight tracks pag. 151

# Chains and accessories

## Part. 701 Sideflex chain

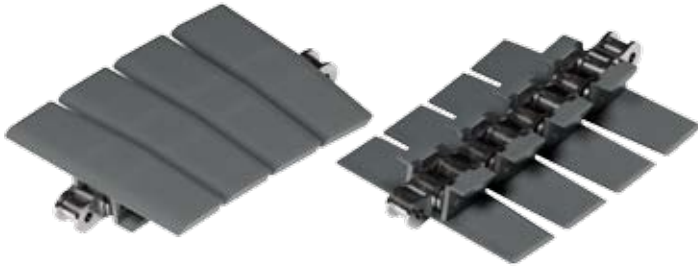

Code  
701 / 84203

**MATERIALS:** Top plate made of grey acetal and roller chain made of steel.

**FEATURES:** To be used in the conveyor systems.

**BOX QUANTITY:** 3,048 meters.

**ON REQUEST:**

- Top plates: In polypropylene, different colours.
- Box quantity: According to your request.

**ACCESSORIES:**

- Sprockets: Unified for chains type ASA 40.

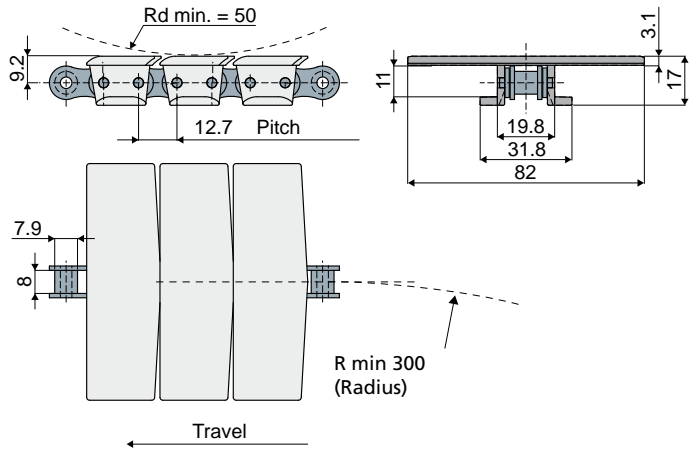

## Part. 702 Top plate (for Part. 701)



Code  
702 / 84205

**MATERIALS:** Top plate made of grey acetal.

**FEATURES:** To be used as spare part for chain Part.701.

**BOX QUANTITY:** 24 pieces.

**ON REQUEST:**

- Top plates: In polypropylene, different colours.
- Box quantity: According to your request.

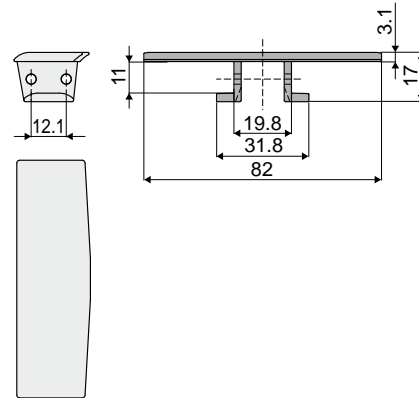

## Part. 703 Sideflexing roller chain



Code  
703 / 84206

**MATERIALS:** Roller chain made of steel.

**FEATURES:** To be used as spare part for chain Part.701.

**BOX QUANTITY:** 3,048 meters.

**ON REQUEST:**

- Chains: In stainless steel.
- Box quantity: 5,003 Mt.

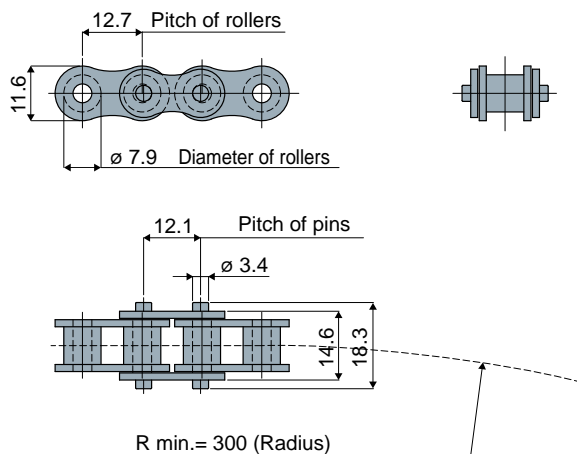

# Chains and accessories

Example of application

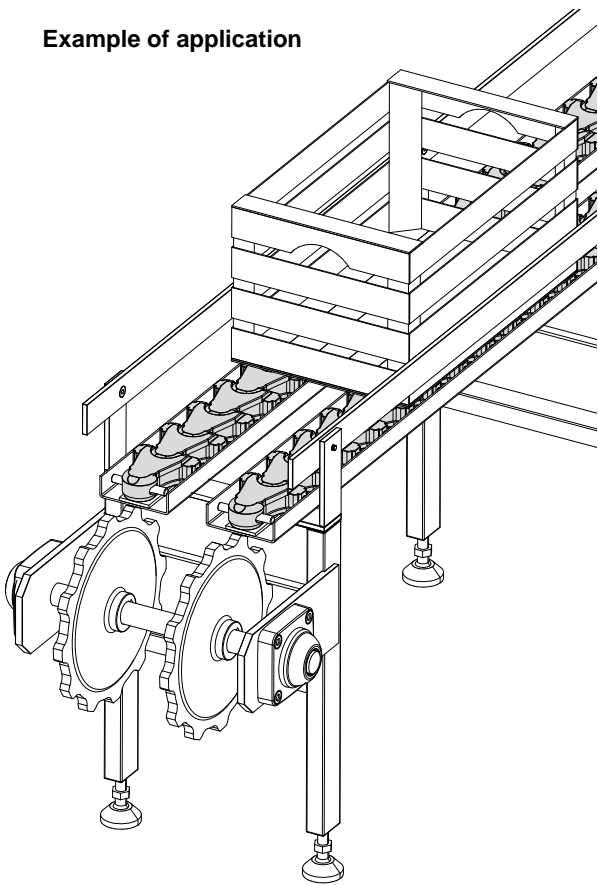

**Cardanic chain**  
(sideflexing for important loads; pitch 80 mm)

Part. **700**

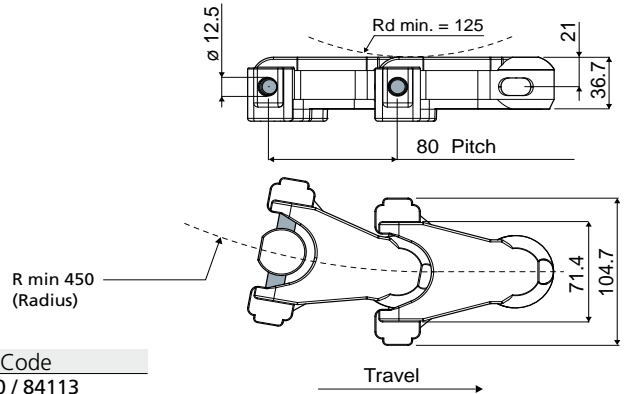

Code  
700 / 84113

**MATERIALS:** Chain made of natural acetal; notch made of polyamide; pin made of stainless steel AISI 430.

**FEATURES:** To be used in the conveyor systems; for important loads (breaking load: 19600 N).

**BOX QUANTITY:** 3,040 meters.

**ON REQUEST:**

- Chains: In different colours.
- Box quantity: According to your request.

**Sprocket T12**  
(for cardanic chain Part. 700)

Part. **704**

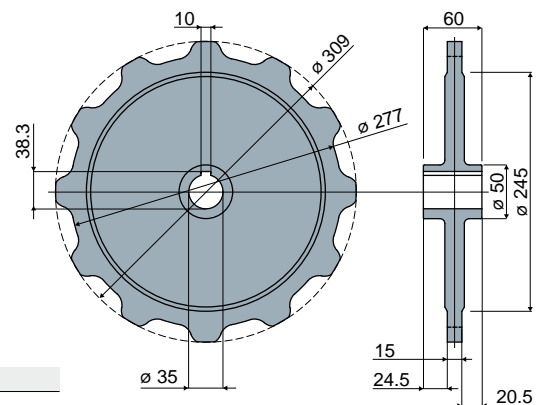

Code  
704 / 84207

**MATERIALS:** Sprockets in zinc plated steel.

**FEATURES:** To be used with chain Part.700.

**BOX QUANTITY:** 2 pieces.

**ON REQUEST:**

- Sprockets: In different materials.
- Box quantity: According to your request.

# Chains and accessories

Part. **710**

**Sideflex chain**  
(Tab 879 Safety Finger)

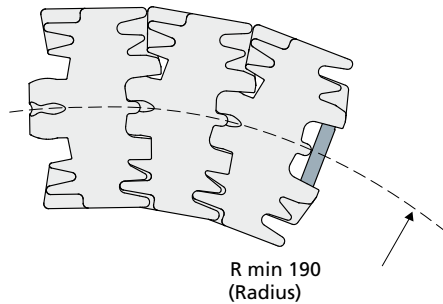
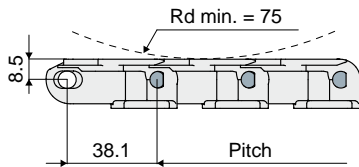
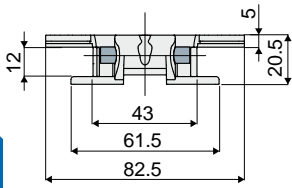
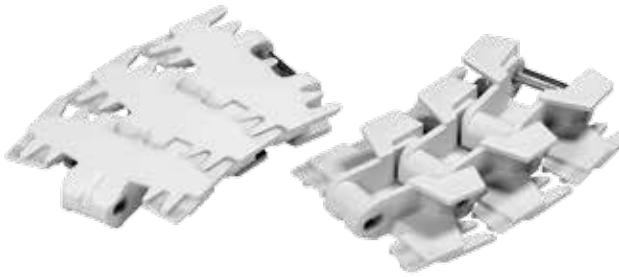

Example of application

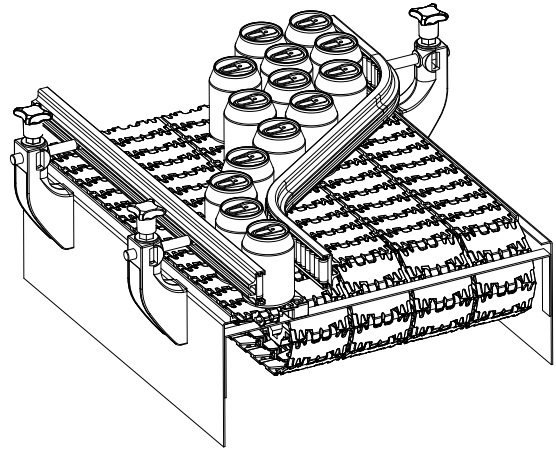

Code

710 / 85400

**MATERIALS:** Top plates made of white colour acetal; pins made of stainless steel AISI 304.

**FEATURES:** To be used in the conveyor systems.

Max. working load: 2100 N.

**BOX QUANTITY:** 3,048 Mt.

**ON REQUEST:**

- Top plates: In different materials; other colours.
- Box quantity: According to your request.

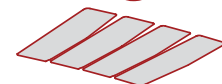

# Chains and accessories

## Example of application

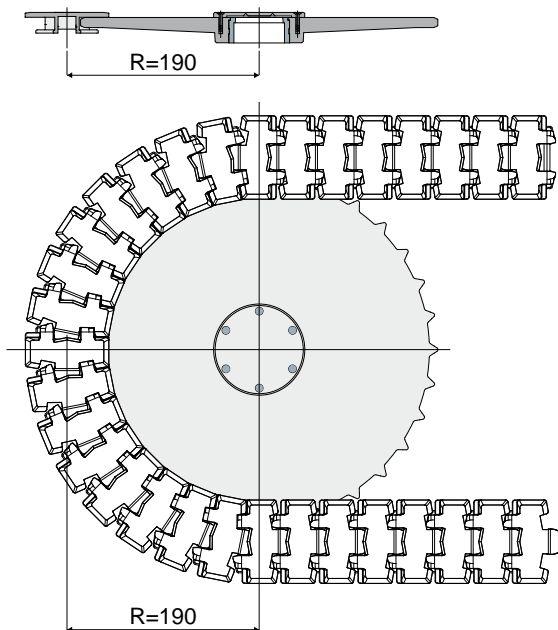

## Sideflex chain (Tab 879 BO)

Part. **711**

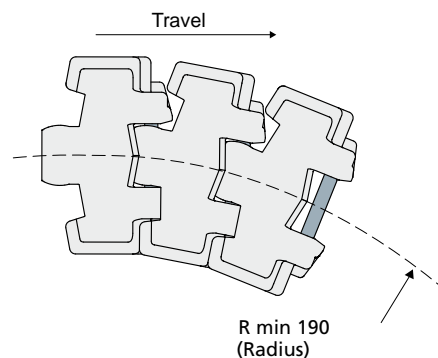
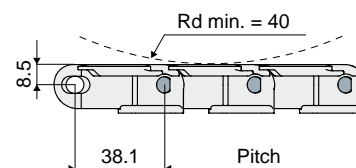
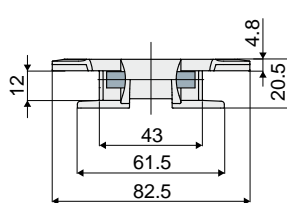

Code	Material	Colour
711 / 86729	Acetal	Brown
711 / 86730	PA + auto-lubricating additive	Black

**MATERIALS:** Top plates in brown colour acetal or in black colour polyamide with auto-lubricating additive; pins in stainless steel AISI 304.

**FEATURES:** To be used in the conveyor systems.

Max. working load: 2100 N.

**BOX QUANTITY:** 3,048 Mt.

**ON REQUEST:**

- Top plates: In different materials; other colours.
- Box quantity: According to your request.

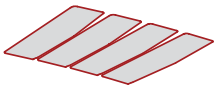

# Chains and accessories

## Part. 705

### Loose link for belt

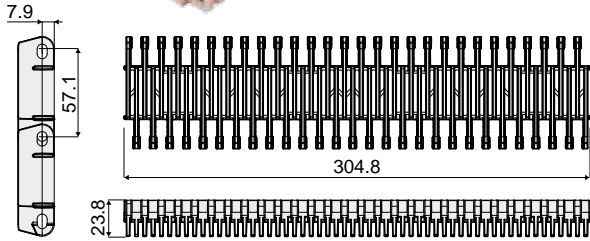

Code

705 / 84208

**MATERIALS:** Loose links in light brown polypropylene.

**FEATURES:**

- Use: Perfect for use in the food industry, it guarantees a uniform conveyor surface.
- Max working load: 29200 N/m (1 mt. belt at + 20°C).
- Working temperature: from +5°C to +105°C.
- Open surface: 34%
- Assembly: with a pin diameter 6 mm (not supplied).

**BOX QUANTITY:** 24 pieces.

**ON REQUEST:**

- Loose links: In acetal.
- Belts: Supplied assembled in different sizes.
- Transfer combs: On request.
- Box quantity: According to your request.

Max working load (N / m)

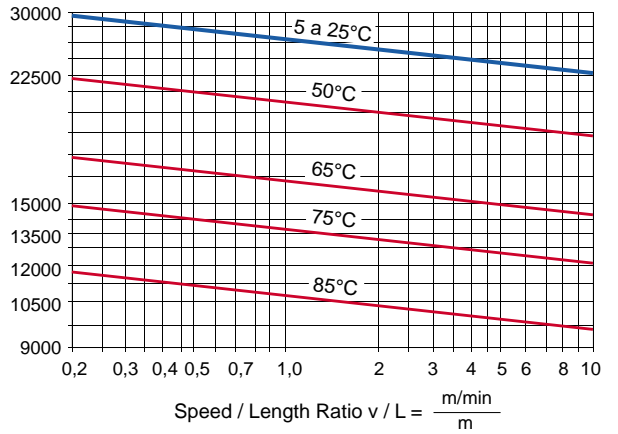

Example of application

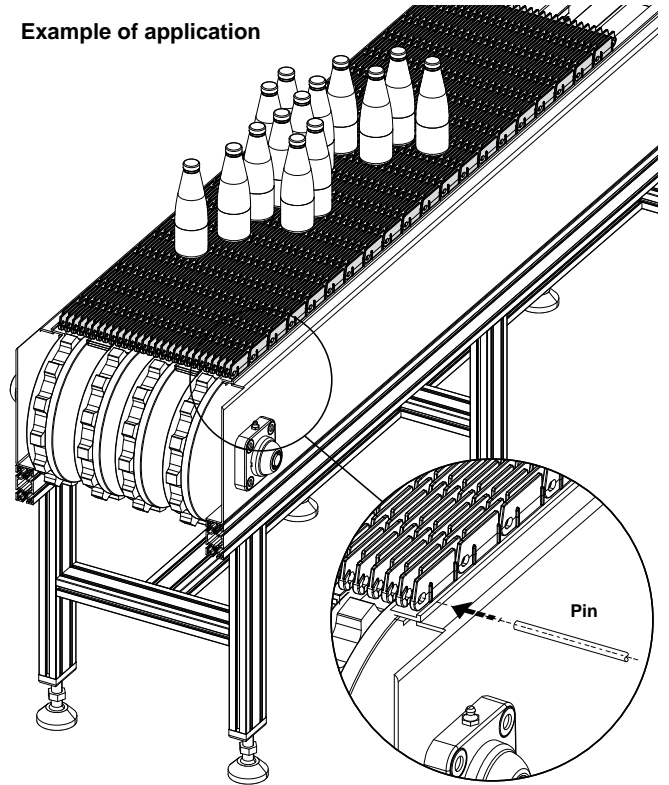

To be used with a pin diam. 6 mm

## Part. 706

### Sprocket / Idler wheel T9 - T14 (for modular belt)

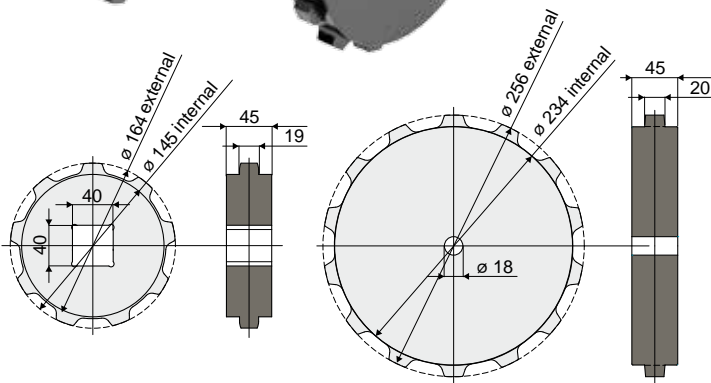
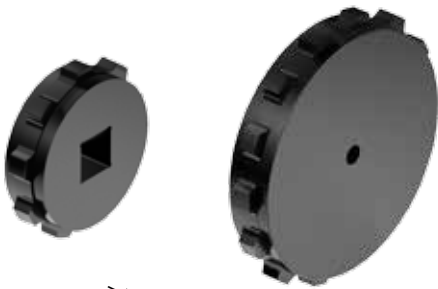

T9	T14
Code	Code
706 / 85850	706 / 84209

**MATERIALS:** Sprockets in black polyamide.

**FEATURES:** To be used with modular belts Part.705.

**BOX QUANTITY:** 2 pieces.

**ON REQUEST:**

- Box quantity: According to your request.



# Corner and straight tracks

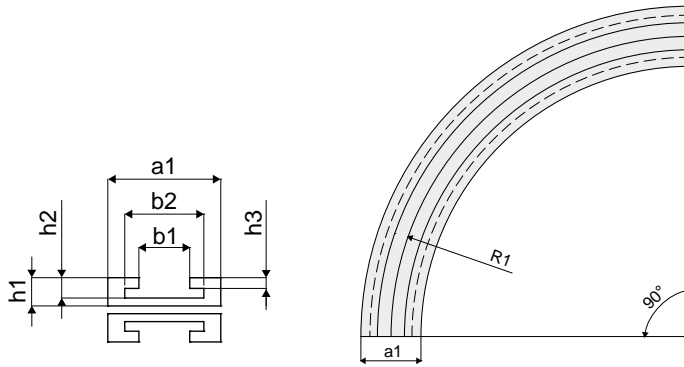

## Corner tracks



Chain type	Chain width	R1 (mm)	a1 (mm)	b1 (mm)	b2 (mm)	h1 (mm)	h2 (mm)	h3 (mm)	Track type	Material	Cod. Tecom
879TAB-K325	82,5	500	100	45	70	25	18	9,5	Carry Return	PE 1000 PE 500	83445
880TAB-K325											83446
881TAB-K325											
8811TAB-K325											
879TAB-K450	114,3	610	125	45	70	25	18	9,5	Carry Return	PE 1000 PE 500	83449
880TAB-K450											83450
881TAB-K450											
8811TAB-K450											
881TAB-K750	190,5	610	200	45	70	25	18	9,5	Carry Return	PE 1000 PE 500	83451
8811TAB-K750											83452

**MATERIALS:** Upper parts in PE 1000, black colour and bottom parts in PE 500 black colour.

**FEATURES:** To be used to drive the chain in the corner sections.

**BOX QUANTITY:** 2 pieces.

**ON REQUEST:**

- **Corner tracks:** Magnetic, with different molecular weight; customised sizes.
- **Box quantity:** According to your request.

## Straight tracks

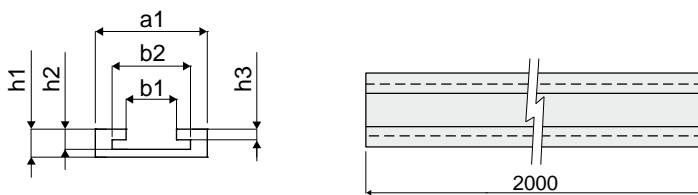

Chain type	Chain width	a1 (mm)	b1 (mm)	b2 (mm)	h1 (mm)	h2 (mm)	h3 (mm)	Material	Cod. Tecom
879TAB-K325	82,5	100	45	70	25	18	9,5	PE 500	83652
879BO-K325									
880TAB-K325									
881TAB-K325									
8811TAB-K325									
879TAB-K450	114,3	125	45	70	25	18	9,5	PE 500	83653
879BO-K450									
880TAB-K450									
881TAB-K450									
8811TAB-K450									

**MATERIALS:** Straight tracks in PE 500 black colour.

**FEATURES:** To be used to drive the chain in the straight sections.

**BOX QUANTITY:** 2 pieces.

**ON REQUEST:**

- **Straight tracks:** With different molecular weight, customised sizes.
- **Box quantity:** According to your request.



**TECOM S.r.l.**

Via A.M. Ampère, 43 - 42017 Novellara (RE) - Italy  
Tel.: (+39) 0522-651203 Fax.: (+39) 0522-756251  
Web: <http://www.tecomsrl.it> e-mail: [info@tecomsrl.it](mailto:info@tecomsrl.it)